

Uninterruptible Power Supplies

Advanced, High Efficiency Back-up Power Sources For Critical Gas and Flame Detection Systems

- * Modular, Rugged Industrial DC-UPS Design
- * Automatic Self-Test feature for UPS function and Battery Voltage
- * Overload Protection in Normal and Backup Operating Modes
- * User-replaceable Batteries Available from Multiple Sources
- * Power Supply, DC UPS and Battery Modules UL508 Listed
- * Optional 480VAC power supply available upon request
- * High Efficiency Fanless Design Requires No Active Cooling
- * Available with 240W or 480W, 24VDC Output
- * Highly Visible LED Status Indicators
- * Dry-Contact Outputs for Battery Fault, Battery Mode, Battery Low
- * Available in Single-Battery and Multiple-Battery Configurations
- * Wide operating temperature range: -20°C to +50°C
- * Two-year Warranty
- * Manufactured in USA

The GDS UPS-X family of advanced, high efficiency DC-based uninterruptible power supplies are designed to provide temporary backup power for critical gas and flame detection systems.

Critical Power Requirements

Typical gas and flame detection systems consist of one or more controllers and multiple remote sensors. In most cases, the controllers provide DC power for the sensors as well as warning horns and strobe lights. A DC UPS connected to the controllers can provide temporary backup power for the entire warning system in the event that main AC power is lost. Even short outages can result in minutes of downtime as the controllers reboot and the sensors reestablish their normal operating conditions.

Microprocessor-Controlled DC-UPS

Typical commercial UPS systems convert incoming AC to DC for storage and then back to AC, which is then converted back to DC by the gas or flame system's power supplies. DC-UPS systems, on the other hand, convert AC to managed DC for use directly by the controller's electronics, improving efficiency and increasing backup time.

UPS Family

The UPS-1 includes a single AC power supply, DC UPS controller and battery in a non-metallic ventilated enclosure, and is capable of providing 6A at 24VDC for up to 30 minutes (see chart on back). The UPS-2 system includes a second AC power supply connected in parallel with the primary supply. This enables the system to provide additional DC power or operate from separate main and backup AC supplies, allowing automatic switch over during power outages. The UPS-3 increases power to 480 watts, allows for an optional second AC supply and supports up to four batteries for extended back-up time or high-current applications.

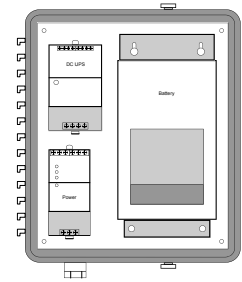

UPS-1
240W, 6A @ 30min

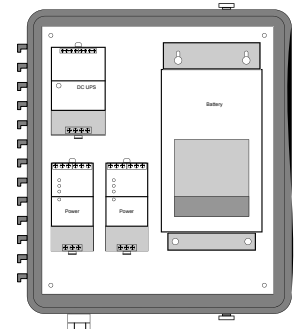

UPS-2
240W, 6A @ 30min
Redundant AC

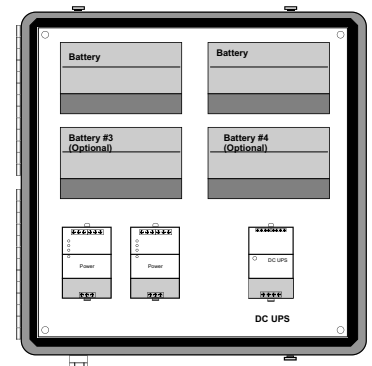

UPS-3
480W, 12A @ 30min
Single or Redundant AC

GDS
Corp

Gas and Flame Detection

2513 Hwy 646

Santa Fe, Texas 77510

409-927-2980 • 409-927-4180 (fax)

www.gdscorp.com • info@gdscorp.com

UPS-1 SPECIFICATIONS	
AC Input	100 to 240VAC, 50/60Hz
DC Ouput	24VDC, 10A (240W)
Batteries	Sealed, maintenance-free lead acid
Recharge Time	8 Hours from Low Battery Indication
Shutdown	Automatic below 22V; Audible alarm for low battery
Temp	-20°C to +50°C Operating
Housing	Non-metallic, vented top and bottom
Dimensions	Width 12.75" (324 mm), Height 14.75" (375 mm), Depth 7.7" (196 mm) Shipping weight 35 pounds (15.8 kg)
Approvals	Power supply only certified for Class I, Div 2, Grps A, B, C, D. UPS UL 60950-1, UL 508, FCC Part 15, Class A
Warranty	2 years from date of shipment

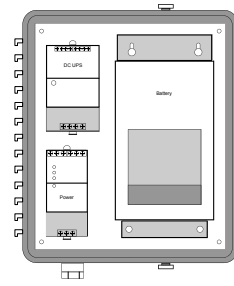

Estimated Backup Time	
Load = 2A	135 min
Load = 4A	52 min
Load = 6A	28 min
Load = 8A	19 min
Load = 20A	14 min

UPS-2 SPECIFICATIONS	
AC Input	100 to 240VAC, 50/60Hz
DC Ouput	24VDC, 10A (240W)
Batteries	Sealed, maintenance-free lead acid
Recharge Time	8 Hours from Low Battery Indication
Shutdown	Automatic below 22V; Audible alarm for low battery
Temp	-20°C to +50°C Operating
Housing	Non-metallic, vented top and bottom
Dimensions	Width 14.75" (375 mm), Height 16.75" (425 mm), Depth 9" (229 mm) Shipping weight 38 pounds (17.2 kg)
Approvals	Power supply only certified for Class I, Div 2, Grps A, B, C, D. UPS UL 60950-1, UL 508, FCC Part 15, Class A
Warranty	2 years from date of shipment

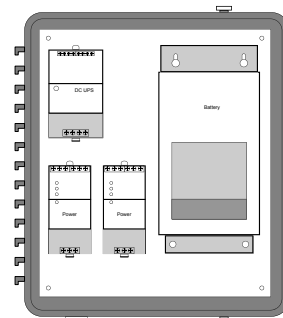

Estimated Backup Time	
Load = 2A	135 min
Load = 4A	52 min
Load = 6A	28 min
Load = 8A	19 min
Load = 20A	14 min

UPS-3 SPECIFICATIONS	
AC Input	100 to 240VAC, 50/60Hz
DC Ouput	24VDC, 20A (480W)
Batteries	Sealed, maintenance-free lead acid
Recharge Time	8-24 Hours from Low Battery Indication
Shutdown	Automatic below 22V; Audible alarm for low battery.
Temp	-20°C to +50°C Operating
Housing	Non-metallic, vented top and bottom
Dimensions	Width 24" (610 mm), Height 24" (610 mm), Depth 8" (203 mm) Shipping weight 90 pounds (41 kg) in full configuration
Approvals	Power supply only certified for Class I, Div 2, Grps A, B, C, D. UPS UL 60950-1, UL 508, FCC Part 15, Class A
Warranty	2 years from date of shipment

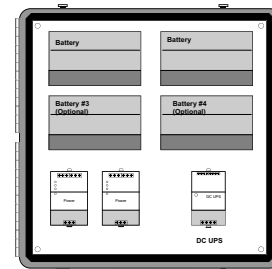

Estimated Backup Time			
Batteries	2	3	4
Load = 4A	116 min	178 min	237 min
Load = 8A	50 min	80 min	113 min
Load = 12A	28 min	46 min	65 min
Load = 16A	17 min	31 min	43 min
Load = 20A	10 min	20 min	31 min



2513 Hwy 646
 Santa Fe, Texas 77510
 409-927-2980 • 409-927-4180 (fax)
 www.gdscorp.com • info@gdscorp.com